

Project: _____

Item #: _____ Quantity: _____

Model #: _____



Custom Cabinet with Built-In MAX Induction™ Featuring SmartStone™ Top

Model: SRC-651SS (110-120 Volt/US)
 SRC-653SS (220-240 Volt/Int'l)
 SRC-653SSU (220-240 Volt/UK)

Order Guide:

Model Number	Voltage	Peak Power	Plug Type
SRC-651SS	110-120	650 Watts	NEMA 5-15
SRC-653SS	220-240	650 Watts	CEE7/7 Schuko Plug
SRC-653SSU	220-240	650 Watts	BS1363 UK Plug

Short Form Specification:

Unit to be a Spring USA **MAX Induction™**: SRC-_____ (Specify 651SS, 653SS or 653SSU) Model. Installed below a SmartStone™ surface is the SM-651SS, 653SS or 653SSU **Hold-Only** Induction Heating System; Constructed of a metal housing with high-impact, 5mm thick, tempered glass hot top. Features a separate control panel mounted on the front of the cabinet, providing four (4) temperature settings and a large LED hold temperature display, in addition to the features listed below.

Construction & Performance Features:

- Magnetic *SmartScan™* technology heats the metal serving pieces, not the tabletop
- Sealed induction base with flanged cooking surface – for easy mounting
- Control panel can be mounted on the short or long side of the tabletop unit
- Energy saving 650-watt model for product holding (only)
- Choice of four (4) temperature settings
- Choice of seven (7) SmartStone™ tabletop colors

SRC Tabletop Induction Units Featuring SmartStone™ are Custom Units, Designed By You

Simple, Solid State Controls With:

- Power ON/OFF Touch Pad
- Power ON/Pan-Present Indicator Lights
- Four-Position Set-Hold Temperature Control
- Lighted Temperature Indicator

Low	Low-Med	Med-High	High
145 - 155° F	156 - 165° F	166 - 175° F	176 - 185° F
61 - 71° C	72 - 76° C	77 - 82° C	83 - 87° C

- Over/Under Voltage Protection Standard
- Tempered, Black Glass Control Panel Overlay

Standard Warranty:

- One Year, Parts & Labor

Agency Listings:

- FCC
- ETL
- ETL-Sanitation to NSF-4

Available Accessories/Alternate Configurations:

- Induction-Ready Pans & Servers [Spring USA Catalog]
- Built-In, High Power Induction Ranges [See Spec SIR-3]
- Countertop, Portable Induction Ranges [See Spec SIR-1]
- Countertop (Hold-Only) Induction Hot Plate [Spec SIR1]
- Mobile & Custom Configurations [Contact Spring USA]
- Double Ranges Available Upon Request



Project: _____

Item #: _____ Quantity: _____

Model #: _____

**Custom Cabinet with Built-In MAX Induction™
Featuring SmartStone™ Top**

Model: SRC-651SS (110-120 Volt/US)
SRC-653SS (220-240 Volt/Int'l)
SRC-653SSU (220-240V Volt/UK)

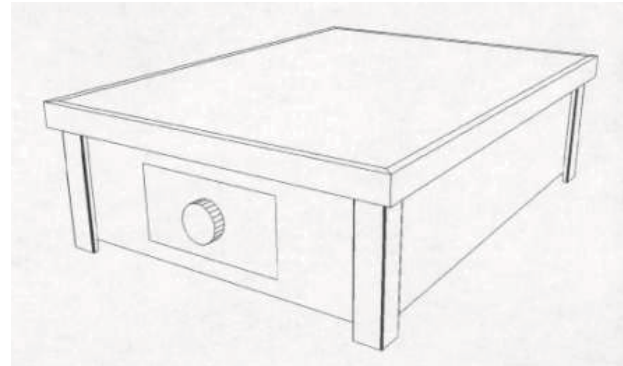
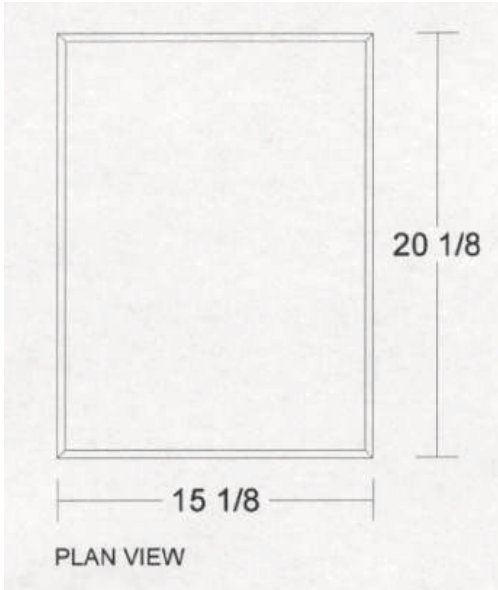

Units are Custom Designed ~
Dimensions Can Vary

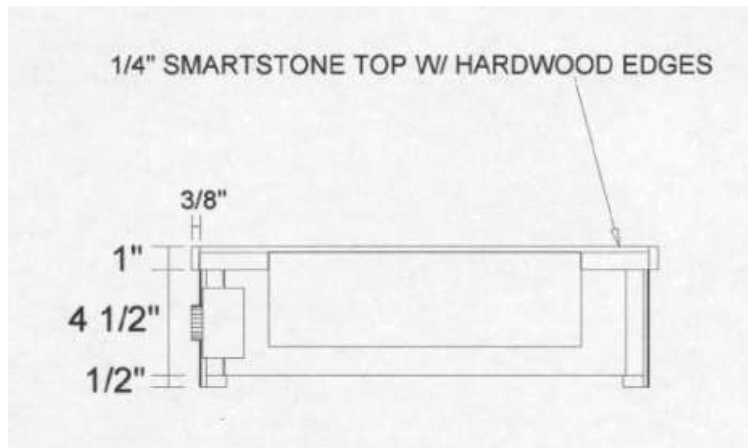
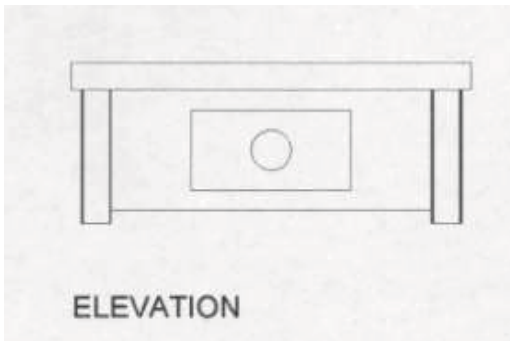

[EC] Electric Requirements:

Model	Voltage	Phase	Hertz	Watts	Amps	Plug
SRC-651SS	110-120	1	50-60	650	5.4	NEMA 5-15P
SRC-653SS	220-240	1	50-60	650	2.7	CEE7/7 Schuko Plug
SRC-653SSU	220-240	1	50-60	650	2.7	BS1363 UK Plug

Notes & Conditions:

1. This induction range requires use of ferrous metal, induction-ready cookware.

Due to continuous product improvement, specifications are subject to change without notice